

LAPIDARIO

REGINA DE MIGUEL

MAY 17 - AUGUST 28 2024

Lapidario is composed of several bodies of work, derived from critical research processes in different disciplines, which have resulted in a set of poetic and propositive works. Drawing from the visual languages of science (botanical, astronomical, cartographic or geological), Regina de Miguel suggests the rethinking of the relationship between human beings and nature on the basis of the possibility of a restorative attitude from the awareness of the fragility shared by all forms of existence and from generosity. The title of the exhibition underlines the forcefulness of the artist's intention, implicit in her proposal.

"The exhibition is a territory of territories. A linking of worlds and a speculative journey that, uniting the telluric with the cosmological, tries to appeal to the consciousness to produce a specific knowledge and a space between languages to evict unequivocal affirmations. Here, humans, animals, microorganisms, stones, and geological strata intertwine in a tentacular interior, using science fiction as a method of tracking and as a political tool that, together with the forensic and the oracular, seeks a dialogue between a federation of living and inert beings that relate in the otherness and the unthinkable, forming a binding frieze."

–Regina de Miguel, April 2024

Born in Malaga in 1977, Regina de Miguel lives and works in Berlin. Her work has been shown individually and collectively in institutions such as: MOCA, Los Angeles, USA (2023); TBA21 / C3A, Cordoba, Spain (2023); Thyssen-Bornemisza National Museum, Madrid (2023); Castello di Rivoli Museo d'Arte Contemporanea, Rivoli-Turin (2023); MACBA, Barcelona (2022); Centro Andaluz de Arte Contemporáneo, Seville, Spain (2022); RADIUS, Center for Contemporary Art and Ecology, Delft, Netherlands (2022); Documenta 15, Kassel (2022); FKV, Frankfurt (2022); Cinemateca de Bogotá, Colombia (2019); Momentum 10 Bienal, Moss, Norway (2019); Goethe Institut, Bogota, Colombia (2019); Kunstraum Kreuzberg Bethanien, Berlin (2018); Instituto Cultural de León, Guanajuato, Mexico (2018); SAVVY Contemporary, Berlin (2018); Haus der Kulturen der Welt, Berlin (2018, 2017, 2014, 2013); CA2M, Madrid (2017); Centre Pompidou, Malaga, Spain (2017); Gaïte Lyrique, Paris (2017); La Casa Encendida, Madrid (2016); Arts Santa Mònica, Barcelona (2016); Kunsthalle São Paulo, Brazil (2014); Palais de Tokyo, Paris (2014); MUSAC, Leon, Spain (2008), among others.

Her work is present in multiple institutional collections, within which is worth mentioning: Reina Sofía Museum (Madrid); TBA21 (Madrid); Centro Andaluz de Arte Contemporáneo (Sevilla, Spain); Botín Foundation (Santander, Spain); Bombas Gens (Valencia, Spain); Centro Gallego de Arte Contemporaneo (Santiago de Compostela, Spain); ARCO Foundation (Madrid); Artium Museoa (Vitoria-Gasteiz, Spain); Universidad Politécnica de Valencia (Spain); Inelcom (Madrid); Caja Madrid (Spain); DKV Collection (Spain); or CRC Fondazione (Cuneo, Italy).

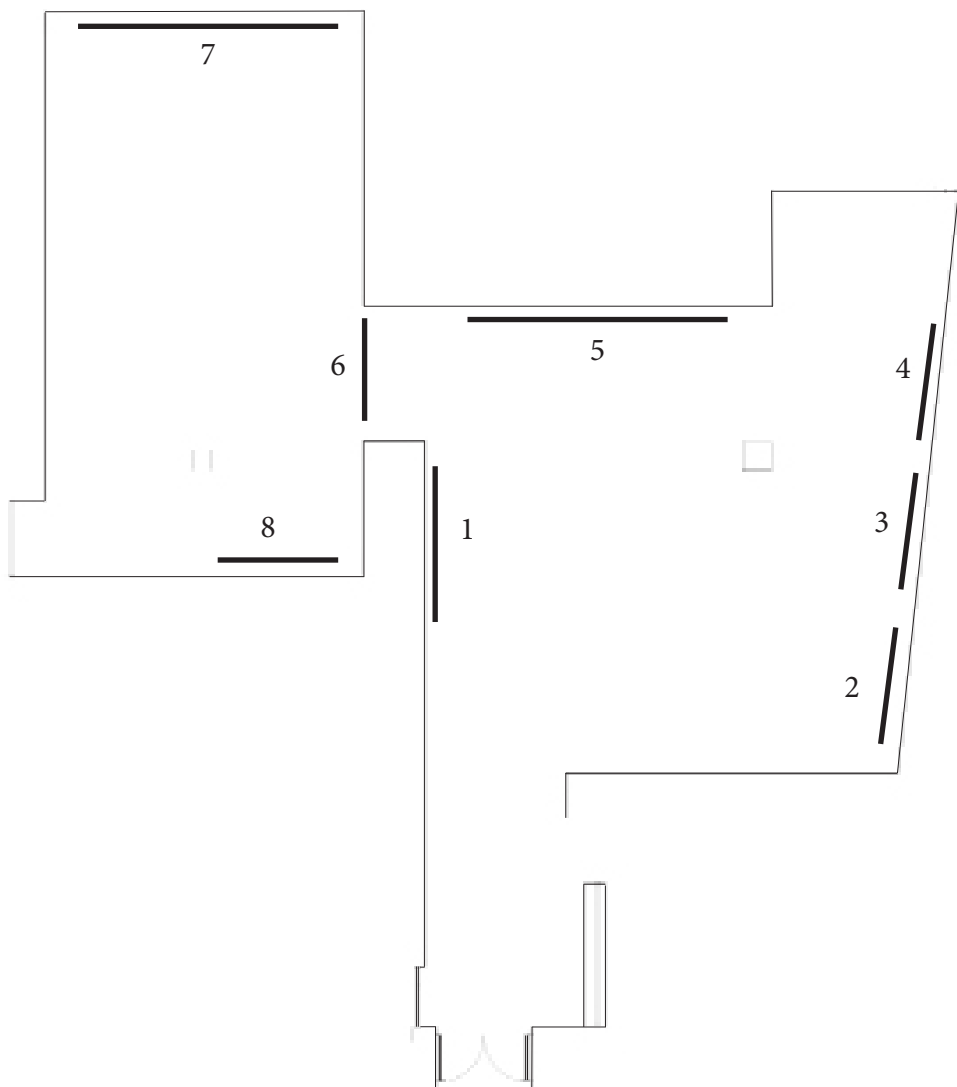

LAPIDARIO

REGINA DE MIGUEL

MAY 17th - AUGUST 31st 2024

1. *Lapidario 2*, 2023-2024. Acrylic on wood. 160 x 200 cm
2. *Mapa/ friso del no ser 1*, 2023-2024. Acrylic on wood. 160 x 200 cm
3. *Mapa/ friso del no ser 2*, 2023-2024. Acrylic on wood. 160 x 200 cm
4. *Mapa/ friso del no ser 3*, 2024. Acrylic on wood. 160 x 200 cm
5. *Ofrenda*, 2024. Polyptych of 14 engravings with varnish on metal, fish hooks, fishing sinkers and gemstones on painted wall. 245 x 450x 4 cm
6. *Portal*, 2024. Acrylic paint on hand embroidered fabric. 320 x 300 cm
7. *AIMISTICA*, 2023. Video HD, 3D Animation. 28m 35s
8. *Exvoto / Arrecife*, 2021. Polyptych of 15 works. Watercolor and gouache on Hannemühle paper. 27,5 x 37,5 cm each